

符合RoHS指令要求
CONFORM TO RoHS INSTRUCTIONS

CN1 & CN2 PIN NO.	1	2	3	4	5	6
LEAD WIRE COLOR	棕	—	红	橙	—	黄

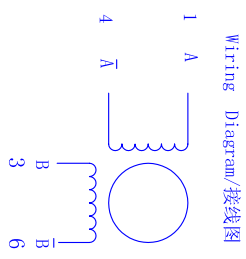
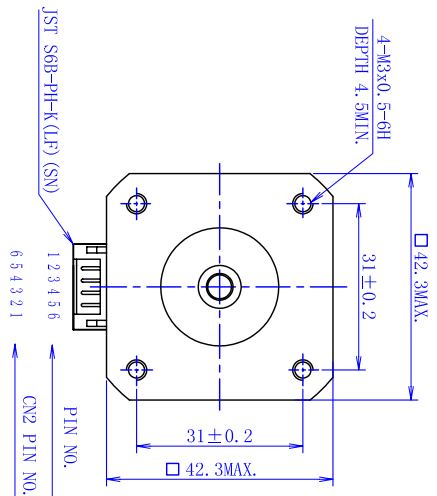
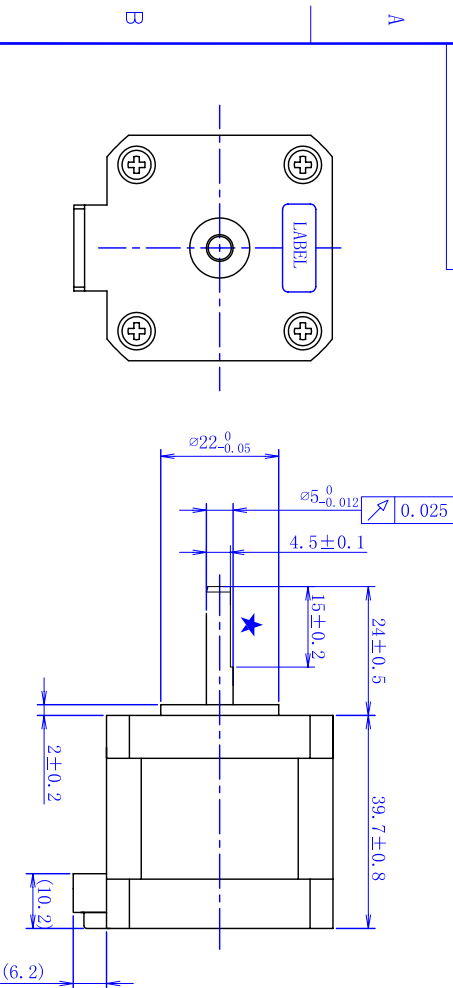

励磁顺序(2相励磁)
EXCITING SEQUENCE(TWO PHASE)

STEP	A	B	\bar{A}	\bar{B}
1	—	—	—	—
2	—	—	—	—
3	—	—	—	—
4	—	—	—	—

电器特性参数/ELECTRICAL PARAMETER

步 进 角 STEP ANGEL	1.8° ±5%
相 数 PHASES	2
额定电压 RATED VOLTAGE	2.34 V
额定电流 RATED CURRENT	1.8 A
电 阻 RESISTANCE	1.3 ohm±10% at 25° C
电 感 INDUCTANCE	2.6 mH±20% at 1k Hz, 1Vrms
保持力矩 HOLDING TORQUE	0.36 N.m(51 oz.in) MIN. NOTE 1)
运行力矩 (—PPS)	— MIN.
RUNING TORQU(RAT —PPS)	(24V.DC,RATED CURRENT, FULL STEP)
绝缘耐压 DIELECTRIC STRENGTH	500V A.C 1分钟/MINITE
绝缘电阻 INSULATION RESISTANCE	100 MΩ 以上./MIN.
绝缘等级 INSULATION CLASS	Class B
温度上升 TEMPERATURE RISE	80K MAX. NOTE 2)
转子惯量 ROTOR INERTIA	57 g.cm ² (0.32oz.in ²)
重 量 WEIGHT	APPRO. 240g (0.53lb)
允许轴向负载 ALLOWABLE THRUST LOAD	15N
允许径向负载 ALLOWABLE RADIAL LOAD	75N(on the shaft end)
环境温度 Ambient temp.	-20° C-----+50° C
环境湿度 Ambient hum.	15%-----90%
寿命 LIFE	5000 HOURS NOTE 3)

NOTE:

1. AT RATED CURRENT, TWO PHASE ON.
2. MEASURED BY RESISTANCE METHOD. MOUNT WITH ALUMINUM HEAT SINK 126*126*15 AT TWO WINDING BE EXCITED BY RATED VOLTAGE, 0PPS, 2PHASE ON.
3. LIFE TEST CONDITION: 2PHASE EXCITING, FULL STEP, AT MAX. STARTING PULSE, BEARING TEMPERATURE SHOULD BE 70° C MAX.

★为客户使用部分
PORTIONS MARKED BY ★ ARE USED BY CUSTOMER

CONFIRMED/ACCEPTED BY CUSTOMER (客户确认/接受)								型号/MODEL	
COMPANY CHIEF SIGNATURE (盖章&签名)								42HS02	
一般公差 TOLERANCE ±0.3/±3°				版本 REV.	日期 DATE	变更 REV. NO.	变更 REV. NO.	初版	
					2012-08-27				
制 图/DRAWN				比例 SCALE		品 名 TITLE		步进电机规格书 STEPPING MOTOR SPECIFICATION	
设计/DESIGNED				单位 UNIT		mm			
审核/CHECKED									
承 认/APPROVED									